

# Facebook Shop Integration - Magento 2

- [Installation](#)
- [Backend Configuration \(Admin side\)](#)
- [Backend Functionality](#)
  - [Facebook Attributes Mapping](#)
  - [Product Feed](#)
  - [Category Products Feed](#)
  - [Import Products Feed](#)
  - [Product Feed Action](#)
  - [Feed Action Logs](#)
- [Frontend Functionality](#)
- [Facebook Account Configuration](#)
- [Demo](#)
- [FAQs](#)
- [Support](#)
- [Additional Services](#)



## Installation



To use this extension, you will require to install MageDelight Base Extension first. If it is not installed then please download it from <https://www.magedelight.com/pub/extensions/magedelight-base.zip> and unzip the package file into the app/code/Magedelight folder of your Magento 2 installation.



Before installing the extension, please make sure to **Backup your web directory and store database**



You will require to install MageDelight Base Extension first. If it is not installed then please download it from <https://www.magedelight.com/pub/extensions/magedelight-base.zip> and unzip the package file into the root folder of your Magento 2 installation.



Root Directory is - "**app/code/magedelight/#YourExtensionName#**"

- Unzip the extension package file into the root folder of your Magento 2 installation.
- Connect to SSH console of your server:
  - Navigate to the root folder of your Magento 2 setup
  - Run command as per below sequence,

```
php bin/magento setup:upgrade
```

```
php bin/magento setup:di:compile
```

```
php bin/magento setup:static-content:deploy
```

```
php bin/magento cache:clean
```

- log out from the backend and log in again



If you are using Magento 2.3 or later then you do not need to activate license. Extension will be activated with silent activation mechanism and does not require activation keys to be entered manually.

## Backend Configuration (Admin side)

### General Configuration

**Enable Facebook Native**  
[store view]

Yes

**Enable Cron Schedule**  
[store view]

Yes

**CRON JOB Frequency**  
[website]

Daily

Define CRON Frequency to generate feed file for facebook.

**CRON JOB Start Time**  
[website]

00

:

00

:

00

Define CRON Start Time. It should be earlier from facebook schedule time for up to date feed.

- **Enable Facebook Native:** Select "Yes" to enable Facebook Shop Integration for your Magento store.
- **Enable CRON Schedule:** Select "Yes" to enable CRON for your store to keep Facebook feeds up to date automatically.
- **CRON JOB Frequency:** Select frequency to run CRON job. You can select daily, weekly or monthly from .
- **CRON JOB Start Time:** Select start time to run CRON job. This should be earlier than Facebook scheduled time to keep your catalog up to date on store front as well as feeds.



When we will CRON, it will generate with product catalog details to be sent on Facebook to update feeds. Automatic CRON helps store owner to keep catalog sync with store and Facebook feed with up to date details. When you change you can set to keep price however reflection on Facebook.

## Backend Functionality

### Facebook Attributes Mapping

## Facebook Attributes Mapping

  demo ▾

Save

Import Csv

 Please Map required field one of (gtin, mpn, brand). Otherwise facebook will reject request.

Facebook Attribute	Magento Attribute
ID ▾	SKU ▾
Availability ▾	Dynamic ▾
Description ▾	Description ▾
Price ▾	Price ▾
Brand ▾	Brand ▾ <span>Delete</span>
<span>Add Attribute Mapping</span>	

- **Facebook Attribute:** Select Facebook attribute to map value of store product. i.e. Facebook's Price attribute should match paroduct's Price attribute.
- **Magento Attribute:** Select Store attribute to map value of Facebook product. i.e. Store's Price attribute should match Facebook's Price attribute.

## Product Feed

### Facebook Shop

Is Allow for Facebook Feed  Yes  
[store view]

- **Allow for Facebook Feed:** Select "Yes" to show this product in Facebook feed. You will find this option in product catalog of Magento.

Products

Add Product

Search by keyword

2046 records found (20 selected)

20 per page

1 of 103

Actions

Delete

Change status

Assign Inventory Source

Unassign Inventory Source

Transfer Inventory To Source

Is Allow for Facebook Feed

Name	SKU	Price	Quantity	Visibility	Status	Is Allow for Facebook Feed	Action
Must Duffle Bag	24-MB01	\$34.00	100.0000	Catalog, Search	Enabled	Yes	Edit
Drive Shoulder Pack	24-MB04	\$32.00	100.0000	Catalog, Search	Enabled	Yes	Edit
Down Summit Backpack	24-MB03	\$38.00	100.0000	Catalog, Search	Enabled	Yes	Edit
Dayfarer Messenger Bag	24-MB05	\$45.00	100.0000	Catalog, Search	Enabled	Yes	Edit

- Enable Facebook Feed for selected products from bulk actions.

## Category Products Feed

Category Products Feed

2 demo

Store View: All Store Views

Assign

Unassign

CATEGORY SELECTION

Category Selection Facebook Feed

- Default Category (1181)
  - What's New (0)
  - Women (0)
    - Tops (784)
      - Bottoms (228)
    - Men (0)
      - Tops (678)
        - Jackets (176)
        - Hoodies & Sweatshirts (208)
        - Tees (192)
        - Tanks (102)
      - Bottoms (304)
    - Gear (46)
    - Collections (13)
    - Training (6)
    - Promotions (0)
    - Sale (0)

- To assign bulk products to show on Facebook feeds, you can assign multiple category wise products from this page.

## Import Products Feed

# Import Products Feed

Import

[Download Sample File](#)

Select File to Import: \*  No file chosen

- You can import products manually to show on Facebook feeds. Please find sample file from above link and import CSV file.

## Product Feed Action

# Product Feed Action

Generate Feed

Facebook Feed Url: \*

Above url only valid after generate atleast one feed, it might be from cron or manual.

- CSV file will be stored on given path, by clicking "Generate Feed" button you can instantly generate feed for Facebook. This will take some time to get reflection on Facebook feed based on Facebook's standard schedule.

## Feed Action Logs

# Feed Action History

Filters

Default View

Columns

Actions

3 records found

20

per page

<

1

of 1

>

<input type="checkbox"/>	Date	Message	Action Type	Status
<input type="checkbox"/>	2019-09-20 06:10:05	Please Map required field one of (gtin, mpn, brand).	Manual	Failed
<input type="checkbox"/>	2019-09-20 06:10:53	Please enter required field value for one of (gtin, mpn, brand). for product Joust Duffle Bag	Manual	Failed
<input type="checkbox"/>	2019-09-20 06:24:39	Feed Generated Successfully	Manual	Success

- This page will show logs of your actions taken for Facebook feeds.

## Frontend Functionality

Page 5 of 13

Copyright © 2021. MageDelight. All Rights Reserved.

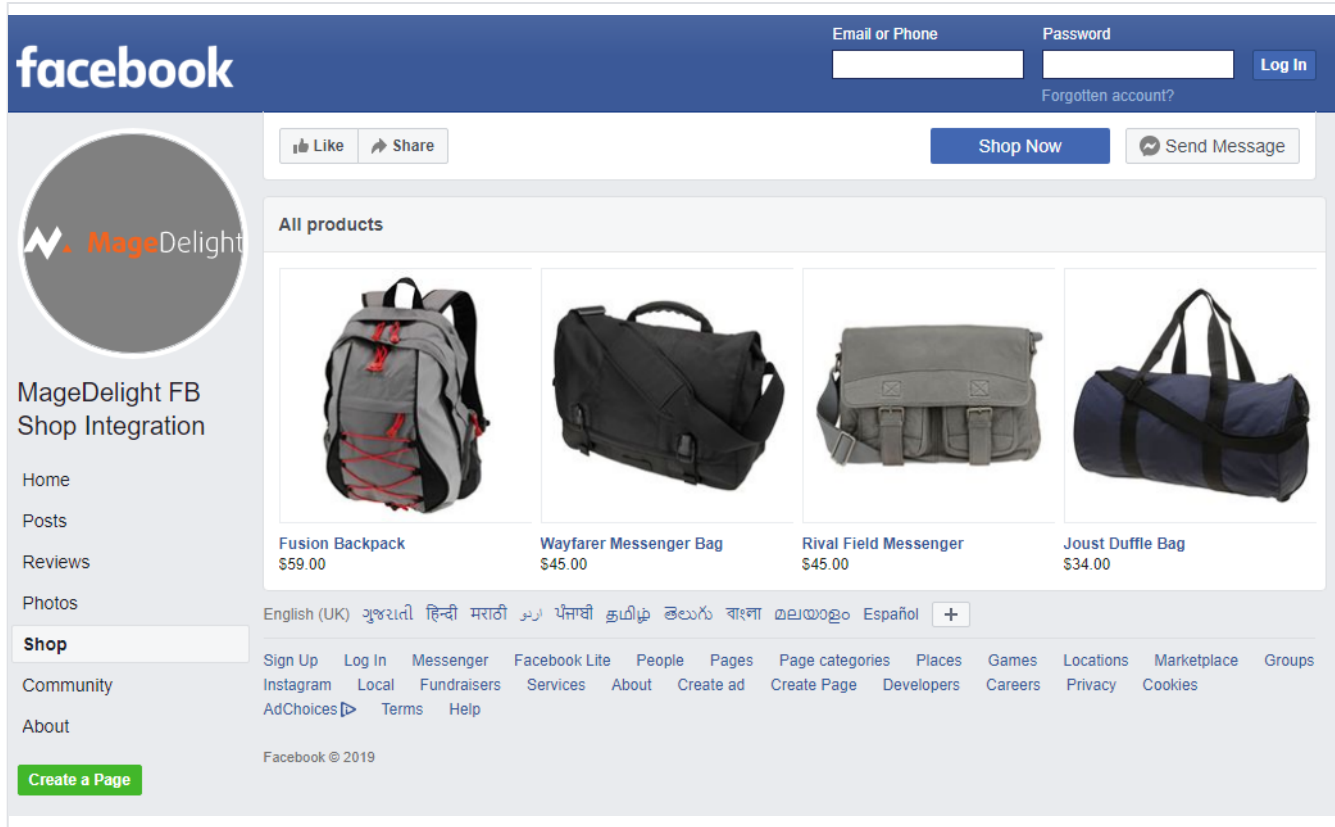

- Sample Facebook Shop integrated with Magento Store Catalog

## Facebook Account Configuration

- Go to your Facebook page that you would like to add the tab, Click on “Settings” at the top right. Click on “Templates and Tabs”,

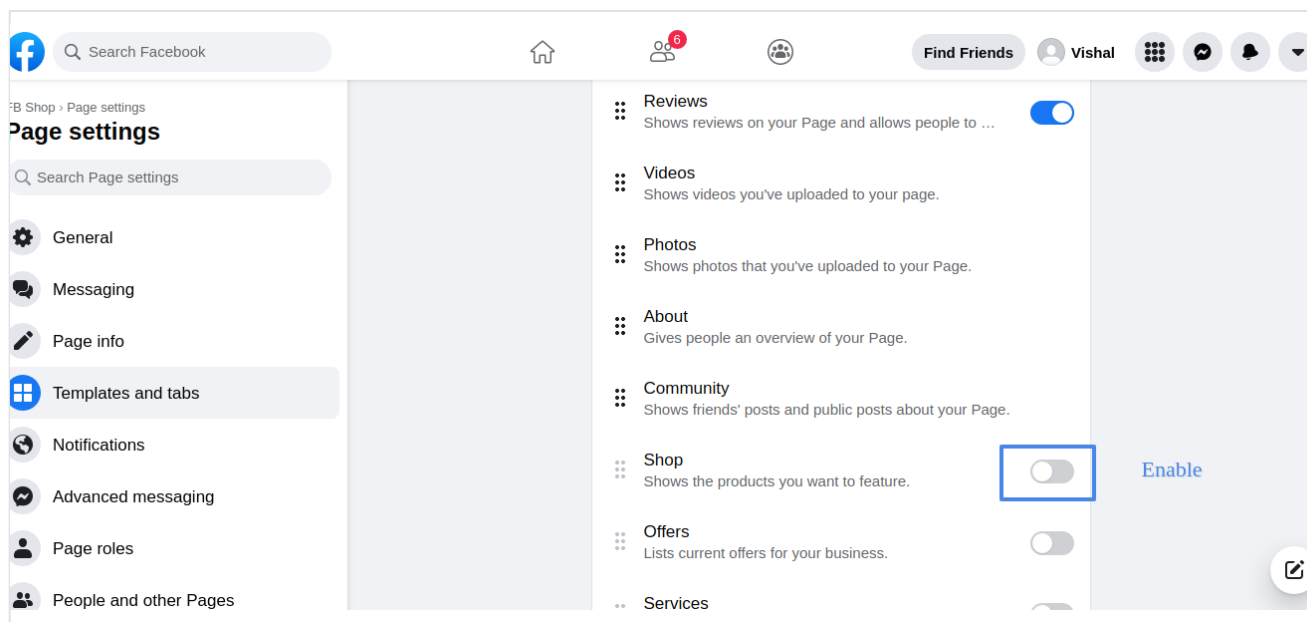

- Scroll at bottom and Click on “Add a Tab” -

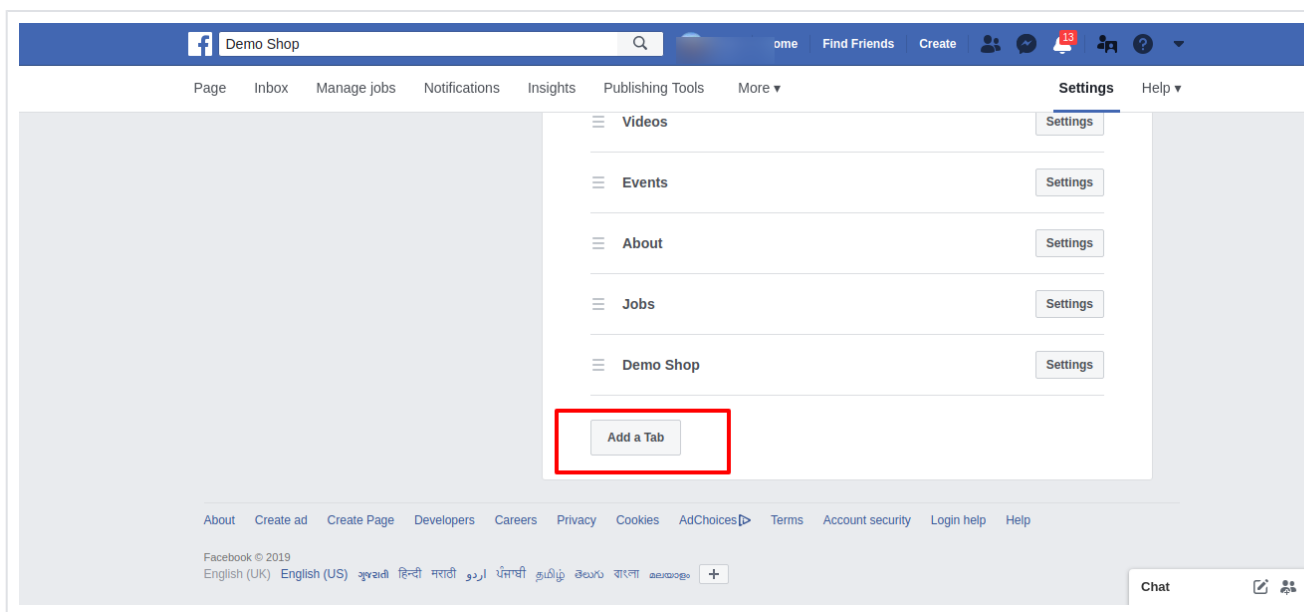

- Click on the “Add Tab” button next to the “Shop” and Click on “Close” to close the popup.

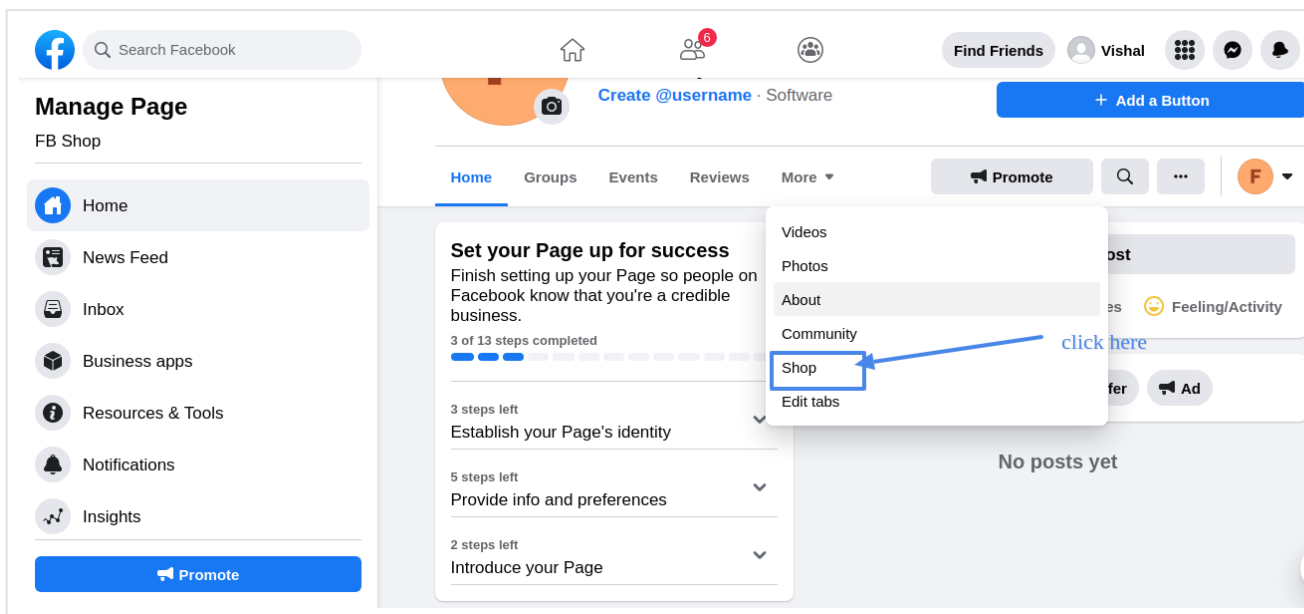

- click on “Page” on the top left, to go back to the page view .

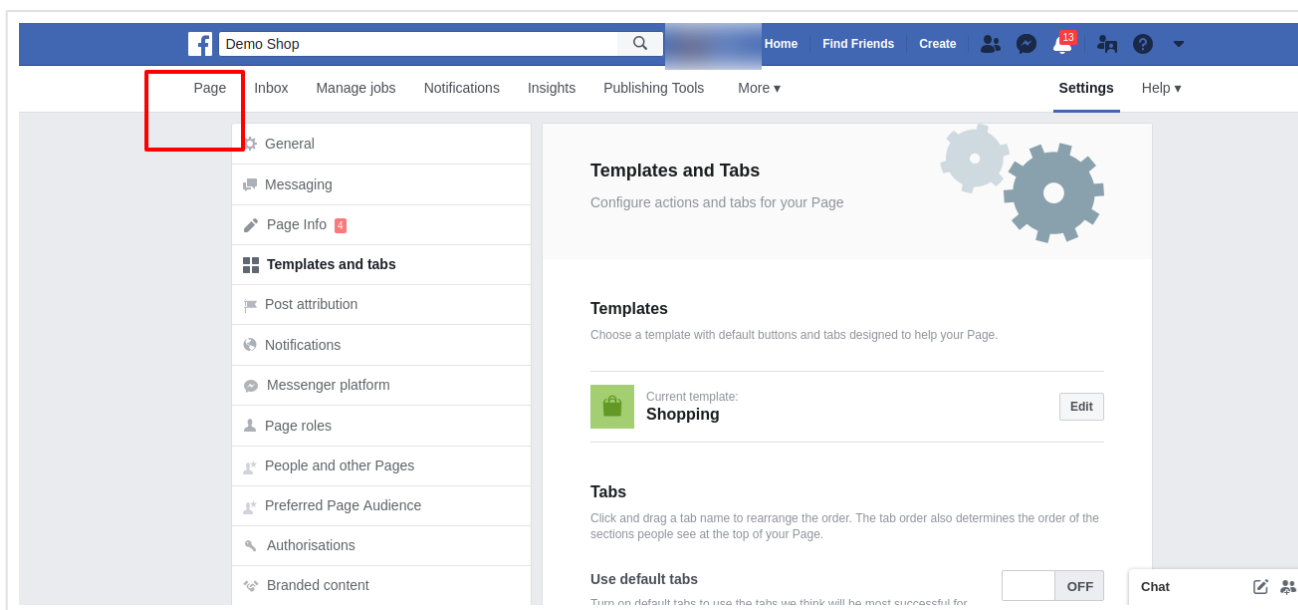

- Now you should see the “Shop” tab in the tabs on the left .
- Click on the “Shop” tab. You should get a popup. Check the terms checkbox, and click “Continue” .

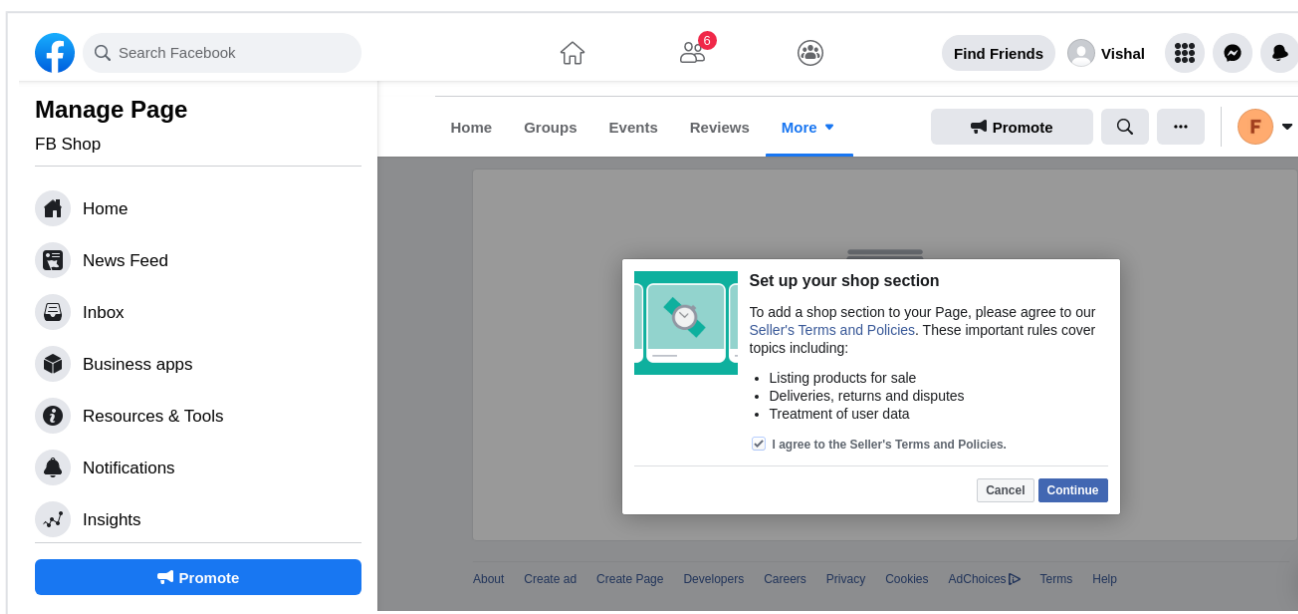

- Now select the checkout method. Select “Check Out.on Another Website” and click “Continue” option.



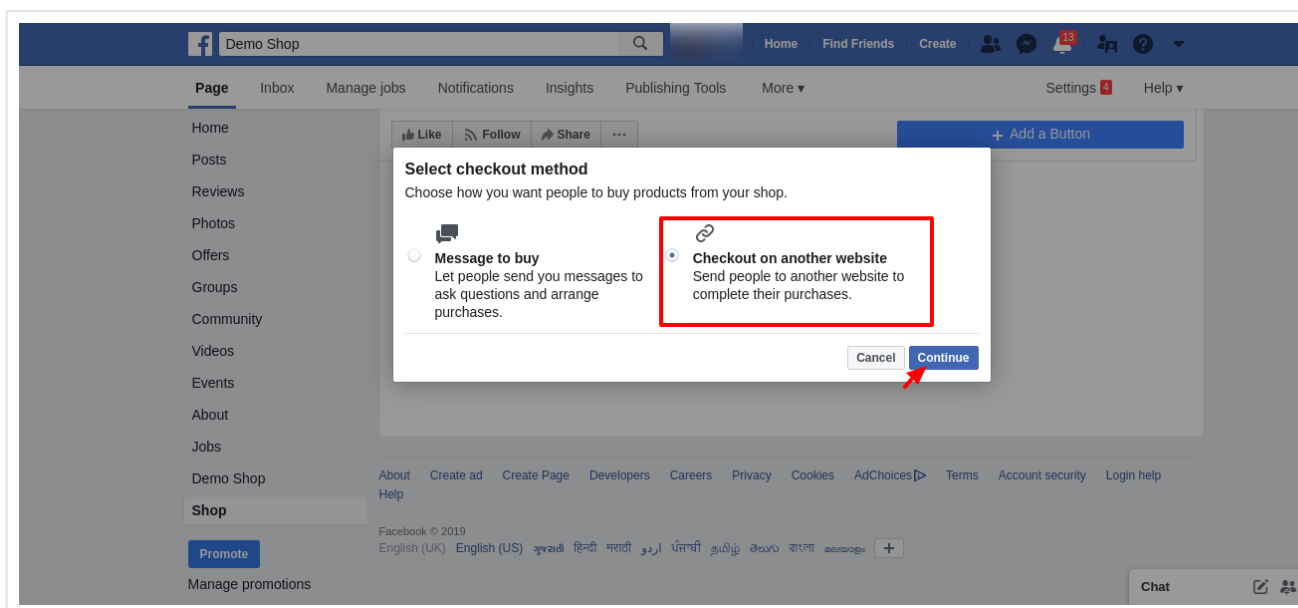

- Another popup will show to set shop currency. Choose the currency of your Magento store, and click "Save"

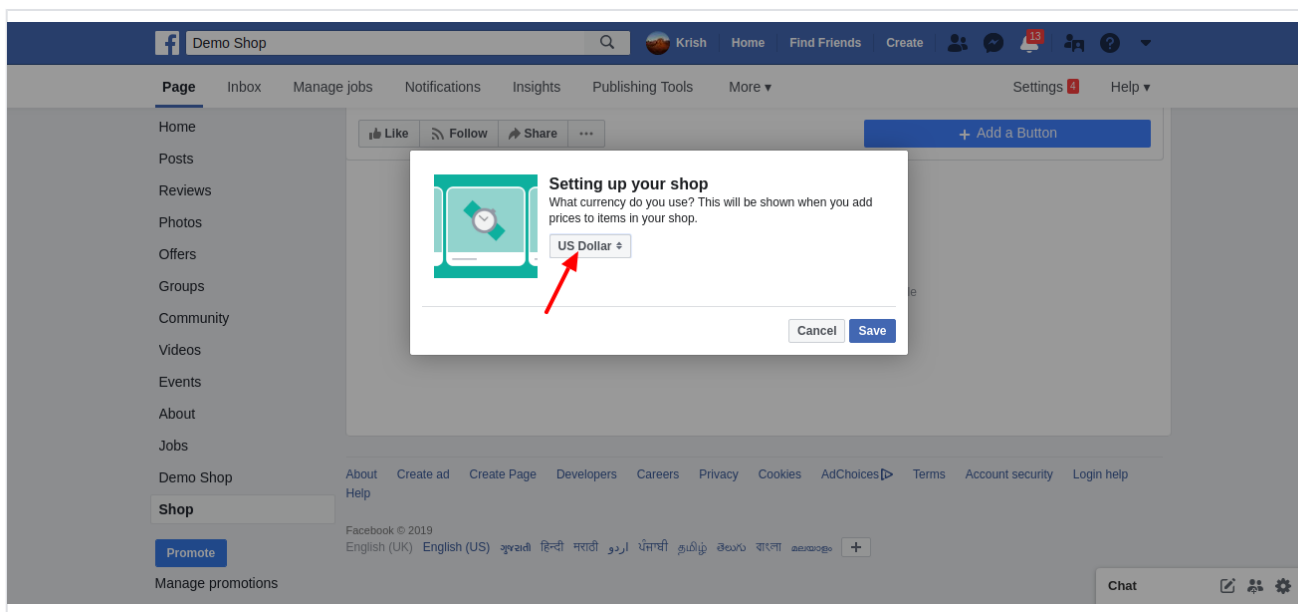

### Set up the catalog feed on Facebook

- Go to the Facebook business manager at <https://business.facebook.com/>. If you don't have a business manager account, simply follow the sign up process.
- Click on "Business Manager" link on the top left . You should see a catalog with the name of your page. (In our example it is "Demo Shirts 2 French"). Click on it .

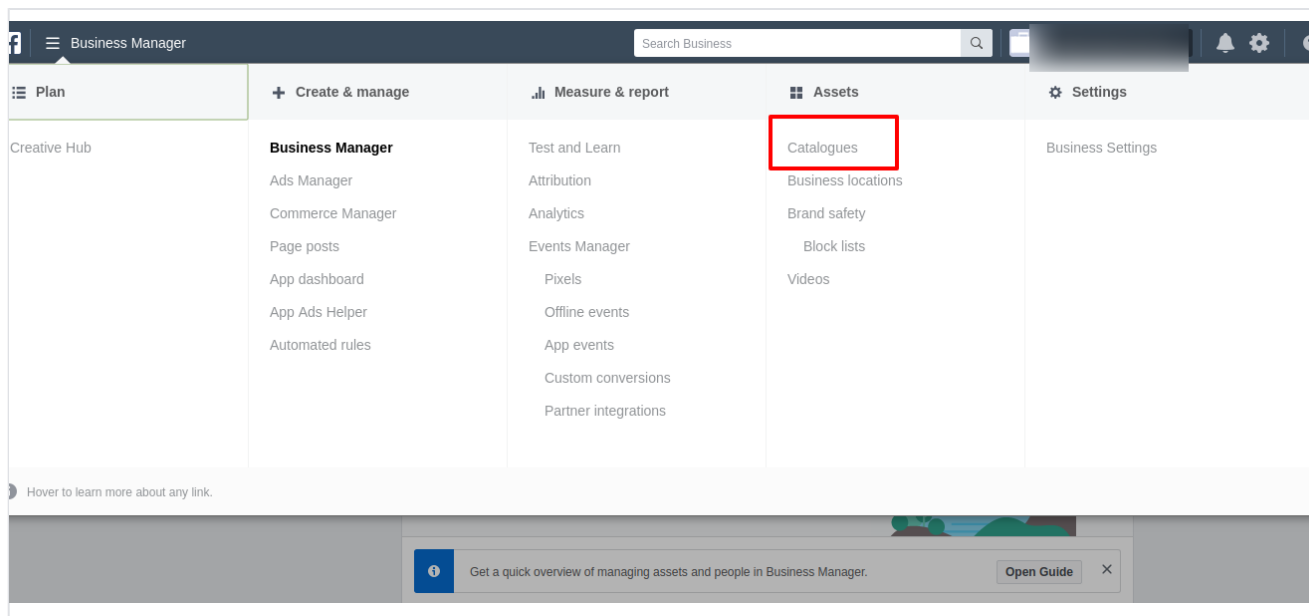

- You should see a catalog with the name of your page. (In our example it is "Demo Shirts 2 French"). Click on it –

Catalogue name ↑↓	Items ↑↓	Role given ⓘ	Owned by ↑↓	Diagnostics	Recommendations
[Blurred]	[Blurred]	No role assigned	FBNativeshop	⚠️ 2 warnings	<a href="#">View use cases</a>
Demo Shirts 2 French Catalogue no.: 44261104...	6 product	No role assigned	Demo Shop	✅ No issues	<a href="#">View use cases</a>
[Blurred]	[Blurred]	Admin	Mage Extensions Store	✅ No issues	<a href="#">Set up Instagram Shopping</a> <a href="#">Create a shop on your Facebook Page</a>

**Help Centre**

[About catalogues](#)

[About Catalogue Manager](#)

[Report a Problem](#)

- Click on "Product Data Sources" -

Catalogues

Current catalogue

View all

Products for Demo Shop ...

Manage

Use cases

Diagnostics

Products

Product sets

Configure

Product data sources

Event data sources

Settings

Collapse

Create Ad

## Use cases

Reach customers on Facebook and Instagram with your catalogue, by running ads and using free shopping features.

### Ways to use your catalogue

You need to finish setting up your catalogue to use these features.

#### Dynamic ads

Reach people with personalised ads that are automatically created to include the products they've shown an interest in or are most likely to buy.

[Learn more](#)

#### Ads to drive traffic

Get more people to view products on your website or mobile app by creating an ad campaign with a traffic objective.

[Report a Problem](#)

- Click on "Add product Data Source" –
- Go to MageDelight > Facebook Shop > Product Feed Action

Catalogues

Current catalogue

View all

Products for Demo Shop ...

Manage

Use cases

Diagnostics

Products

Product sets

Configure

Product data sources

Event data sources

Settings

Collapse

Create Ad

### Use Data Feeds

Upload a data feed file containing product info to control which products are added to your catalog and when. [Learn more](#)

Recommended for more than 50 products or running dynamic ads.

### Connect Facebook Pixels

Use pixels (code installed on your website) to automatically update the products in your catalog each time someone visits them. [Learn more](#)

Recommended for more than 50 products that get updated hourly or daily.

Cancel

Next

Report a Problem

Facebook Catalogs interface showing the 'Need to set up a data feed?' screen. The left sidebar includes 'Current catalogue', 'Manage' (Use cases, Diagnostics, Products, Product sets), and 'Configure' (Product data sources, Event data sources, Settings, Collapse). The main content area has a 'Need to set up a data feed?' section with a note about using the Facebook Feed plugin on Shopify, WooCommerce, BigCommerce, or Magento. Below this is a 'How do you want to upload your data feed?' section with two options: 'Upload once' and 'Set a schedule' (highlighted with a red box). The 'Set a schedule' option is recommended for regular inventory changes. Below this is the 'Enter data feed name' section with a text input field containing 'New data feed for Products for Demo Shop (26485435112949) - 7/25/2019'. A red arrow points from the 'Product data sources' menu item to this field. The 'Select default currency' section shows a dropdown menu set to 'USD - US Dollar'.

- Click on Facebook Feed Url: Paste this url into facebook Add a Data Feed URL.

Facebook Catalogs interface showing the 'Add a data feed URL' screen. The left sidebar is the same as the previous screenshot. The main content area has an 'Add a data feed URL' section with instructions on URL types. Below this is a 'Data feed URL' text input field. A red arrow points to this field. Below the URL field is the 'Add your data feed URL login details (optional)' section with 'Username' and 'Password' fields. A red arrow points to this section. Below this is the 'Schedule your automatic uploads' section with radio buttons for 'Hourly', 'Daily', and 'Weekly'. The 'Hourly' option is selected, and a red arrow points to it. Below this is the 'Enter data feed name' section with a text input field containing 'New data feed for Products for Demo Shop (26485435112949) - 7/25/2019'. A red note on the right side of the screen says 'copy url from: Magedelight > Facebook Shop > Product Feed Action'.

- Now go to your Facebook page Shop tab
- Click on one of the products. You will most likely see the message "Your product is being processed", as said it means that Facebook is still processing your product. On a first upload it usually takes between 10 minutes or an hour.

Catalogues

Search

13

Current catalogueView all

Products for Demo Shop ...

Manage

Use cases

Diagnostics

Products

Product sets

Configure

Product data sources

Event data sources

Settings

Collapse

Create Ad

Product data sources

Data sources show where your catalogue information comes to Facebook from. You can upload your information from multiple sources at once.

All data sources

Search by source name or ID

Data source name ↑↓	Source type	Last update ↑↓	Status	Next update
No data sources found.				

Add products

Report a Prot

## Demo

[Click here](#) to visit frontend.

[Click here](#) to visit admin panel.

## FAQs

[Click here](#) to visit FAQs.

## Support

[Click here](#) to raise a support ticket using your MageDelight account.

## Additional Services

[Click here](#) to get the customized solution for this extension.

Thank you for choosing **MageDelight!**

Page 13 of 13

Copyright © 2021. MageDelight. All Rights Reserved.